

# The CareAttend App

## Creating a Passcode

To use the CareAttend app, you need to create a Passcode

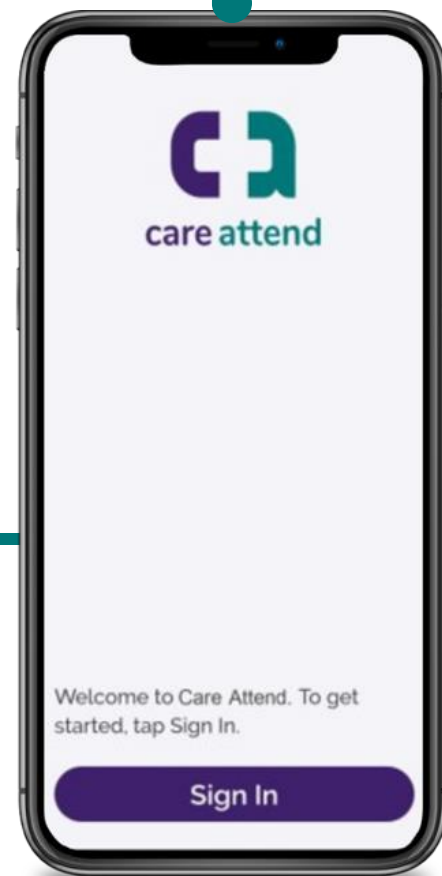

1

Tap Sign In and choose a sign in method



2

Select Consumer Direct and tap Next

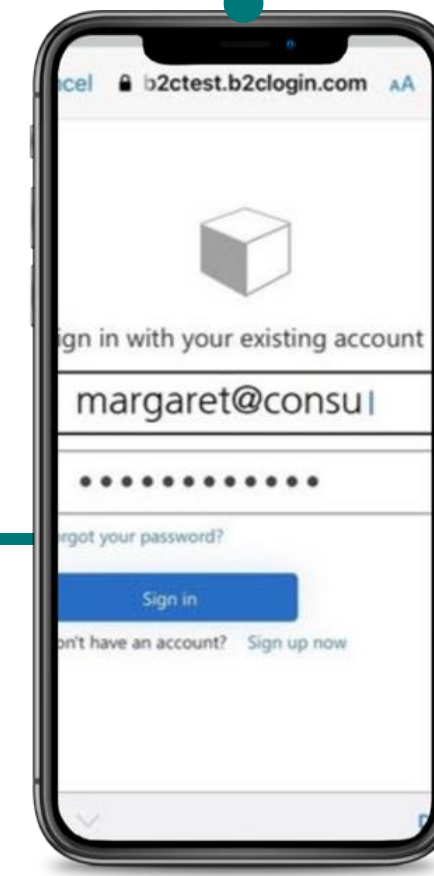

3

Enter your information and tap Sign in

Note: You will be given your ID and login credentials during the enrollment registration process.

# The CareAttend App

## Creating a Passcode

Sign up to a CareAttend account

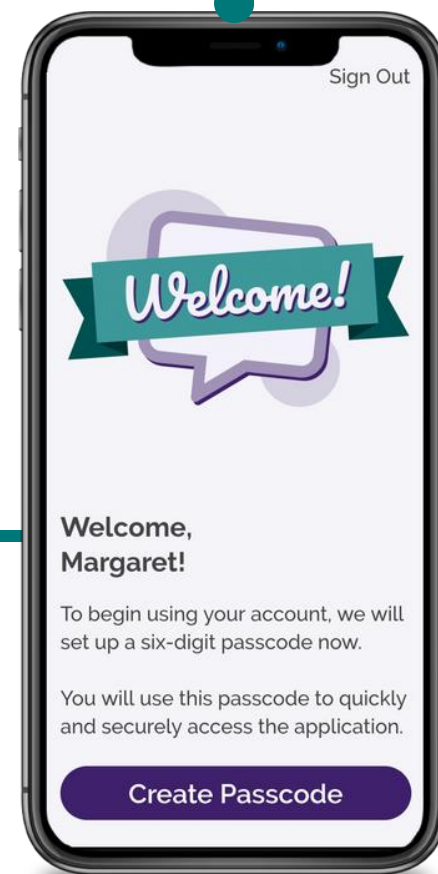

4

Tap Create Passcode

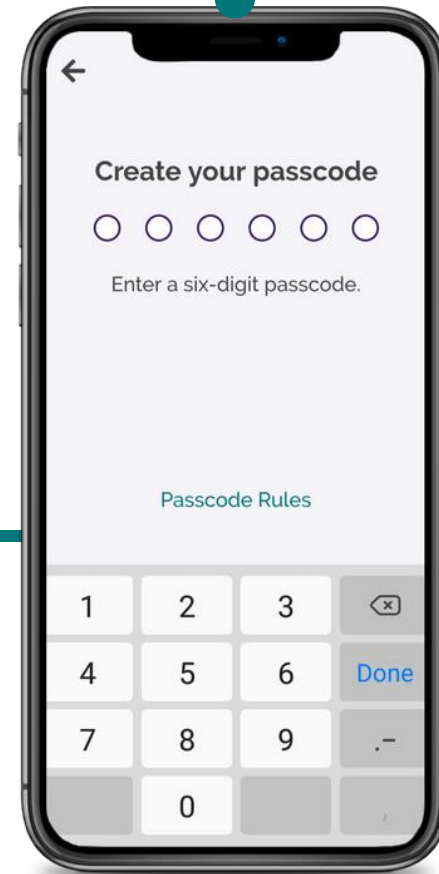

5

Choose a six-digit passcode that meets the requirements

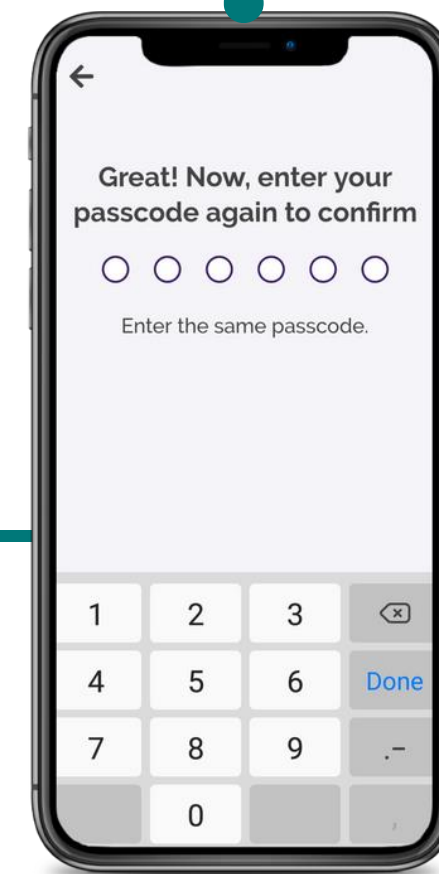

6

Enter and Confirm your passcode



7

You can now sign in with your Passcode